



Please take time to read these safety precautions carefully before connecting your machine to the power supply. It is essential to follow them and the operating instructions.

- First read this entire operating manual.
- To avoid damage, only use capsules designed for this system with this machine.
- Danger of electric shock! Never immerse the appliance in water or any other liquid.
- Connect only to a properly grounded power point (230V) protected by at least a 10 A fuse.
- To make sure that the appliance is switched off, remove the plug from the power point.
- Never clamp or run the power cable over sharp corners or edges.
- Danger of electric shock! Damaged power cables may only be replaced at the customer service centre.
- Danger of electric shock! Never touch the power plug/socket/cable or the appliance with damp or wet hands. Never unplug by pulling out the power cable; always remove the plug.
- If you need an extension cable, make sure it is suitable for your appliance (3-pole grounded, 1.5 mm<sup>2</sup> conductor cross-section), and lay the cable to avoid tripping.
- We recommend connecting the appliance via an FI circuit-breaker. Consult a specialist if in doubt.
- Danger of scalding! Never move the appliance during operation!
- Never operate the appliance without water.
- Danger of burning! Never touch very hot parts of the appliance (e.g. brew unit during operations).
- Danger of scalding! Do not touch the water jets.
- Danger of scalding! Do not move the operating lever when the appliance is still under pressure making coffee.
- Choose a dry, stable and level support surface for the appliance not immediately underneath the power point, at least 60 cm away from the washbasin and taps.
- Never place the appliance on flammable/fusible surfaces or equipment.

**Intended utilization**  
The Ventura XS200 Automatic capsule machine is designed only to make espressos and coffee.

**Congratulations!**  
This Ventura XS200 Automatic capsules coffee machine is a first-class product, manufactured with the greatest care. If you look after it properly it will reward you with many years of good service.

**Before using your new machine, please read this operating manual carefully, keep it safe and pass it on to the next user. For further information please contact the service and sales centre.**

**After unpacking, please check that the following parts are included:**

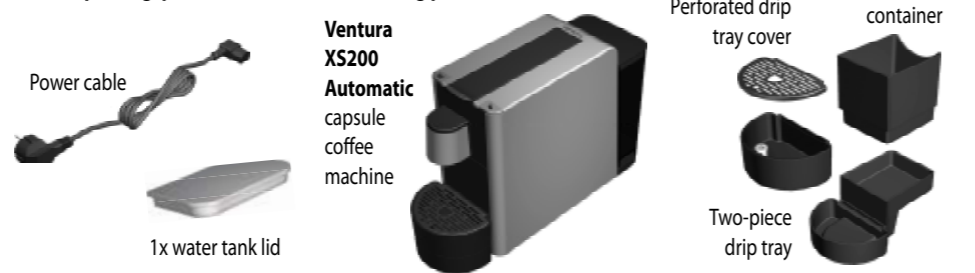

**Caution**  
• Check that your power supply voltage is the same as marked on the machine rating plate (220-240 V).  
• Destroy all the plastic bags to prevent danger to children!

**Note**  
• there can be remaining water in the tank from the function testing before leaving the factory.  
• Coffee capsules are not included!

**1. Before using for the first time**

Thoroughly rinse out the water tank with hot water before using for the first time. Clean the capsule coffee machine using a damp cloth only (see **11. Cleaning the appliance**).

Do not use the appliance in case of:  
– faulty operation.  
– damaged power cable.  
– after falling or other damage.  
In such cases immediately have the appliance checked and repaired if necessary at the customer service centre.

**Caution**  
• Danger of tripping! Do not let the power cable hang down.  
• Danger of electric shock! Never clamp or run the power cable over sharp corners or edges or hot surfaces.  
• To make sure that the machine is switched off, remove the plug from the power point.  
• Danger of scalding; beware of hot water.  
• Do not operate the machine with an empty water tank.  
• Always pull out the power plug before cleaning the machine.

**2. Installation / Power connection**

The machine location must meet the following requirements:  
• Place the machine on a dry, stable and level surface, not directly under the power point. Only use the machine in a dry room.  
• Never place the machine or power cable on or nearer than 50 cm to hot surfaces or open flames.  
• Never place the machine nearer than 60 cm to the wash basin.  
• If you need an extension cable, make sure it is suitable for your machine (3-pole grounded, 1.5 mm<sup>2</sup> conductor cross-section).  
• Remove the protective foil from the perforated drip tray cover and insert it in the drip tray.

**Note**  
Before using for the first time the internal piping must be flushed out (for details see: **9. Flushing machine and internal piping**).

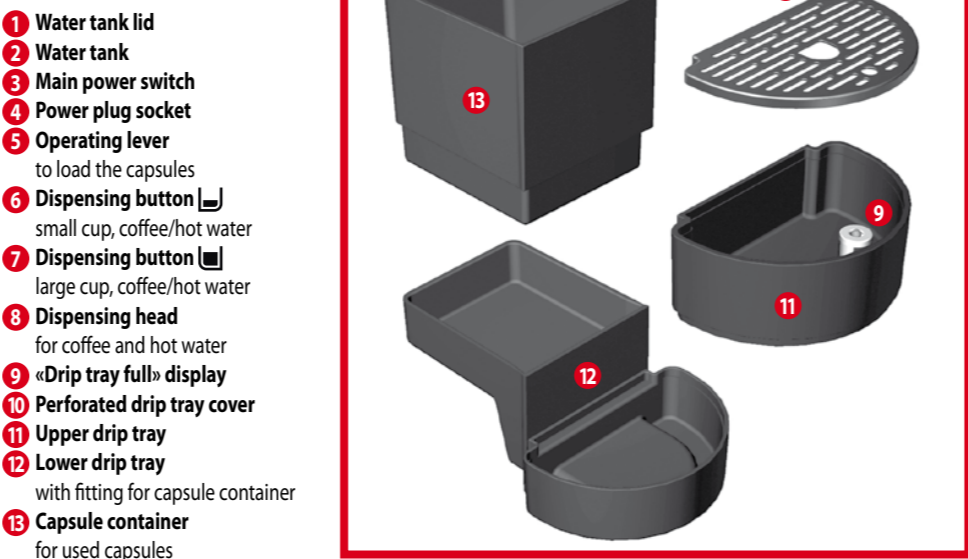
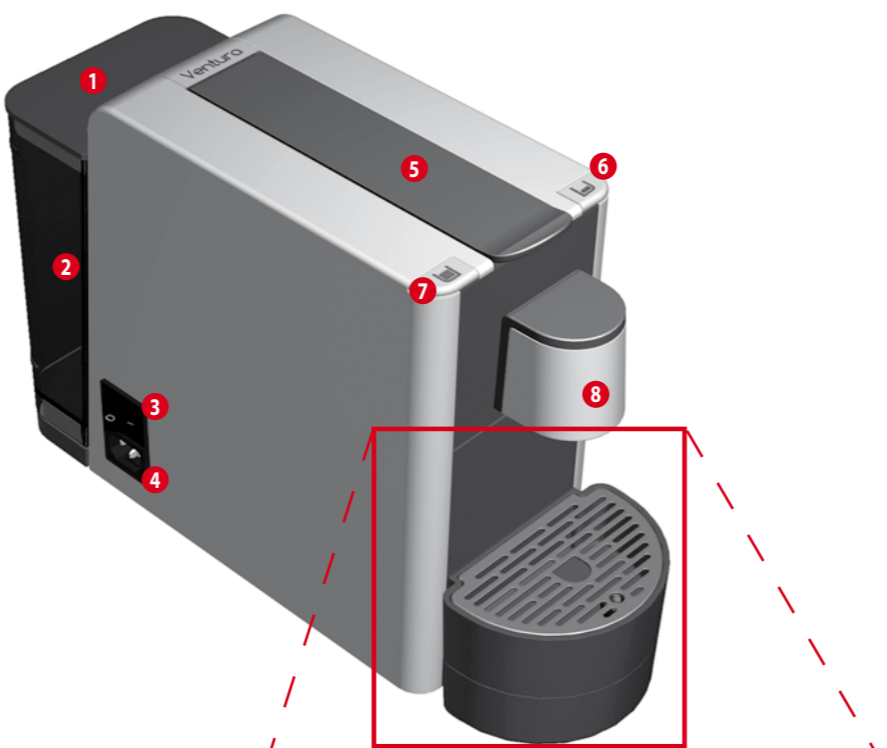

- 1 Water tank lid**
- 2 Water tank**
- 3 Main power switch**
- 4 Power plug socket**
- 5 Operating lever** to load the capsules
- 6 Dispensing button** small cup, coffee/hot water
- 7 Dispensing button** large cup, coffee/hot water
- 8 Dispensing head** for coffee and hot water
- 9 «Drip tray full» display**
- 10 Perforated drip tray cover**
- 11 Upper drip tray**
- 12 Lower drip tray** with fitting for capsule container
- 13 Capsule container** for used capsules

**3. Filling the water tank**

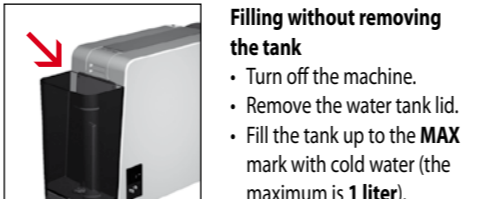

**Filling without removing the tank**  
• Turn off the machine.  
• Remove the water tank lid.  
• Fill the tank up to the **MAX** mark with cold water (the maximum is **1 liter**).  
• Replace the lid.

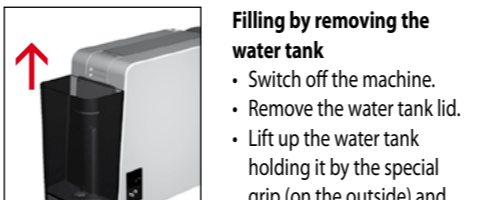

**Filling by removing the water tank**  
• Switch off the machine.  
• Remove the water tank lid.  
• Lift up the water tank holding it by the special grip (on the outside) and remove it pulling upwards.  
• Fill the tank up to the **MAX** mark with cold water (the maximum is **1 liter**).  
• Lower the water tank into place, pushing firmly.  
• Replace the lid.

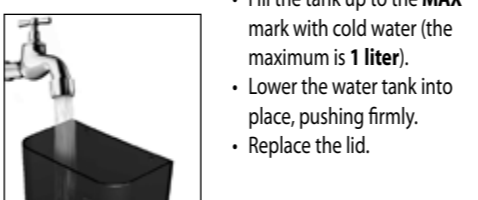

**Note**  
• Never use distilled water.  
• Use only cold tap water.  
• After filling the water tank, and before the next time that coffee is dispensed, press one of the dispensing buttons, until you obtain a regular flow of water from the dispenser (without the capsule).  
• Water which has been softened with a commercially available water filter can be used. Damages caused by wrong handling of the water filter are not covered by the guarantee.  
• If the water tank is empty the pump sounds very loud. This does not indicate any malfunctioning. Press one of the dispensing buttons and the pump is immediately deactivated.  
• If no dispensing button is pressed, the pump is automatically deactivated after 2 minutes.

**4. Starting up / Preheating**

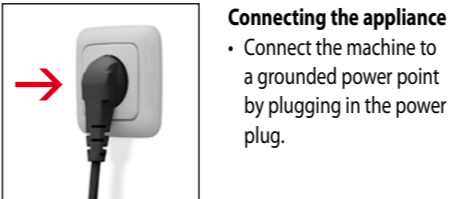

**Connecting the appliance**  
• Connect the machine to a grounded power point by plugging in the power plug.

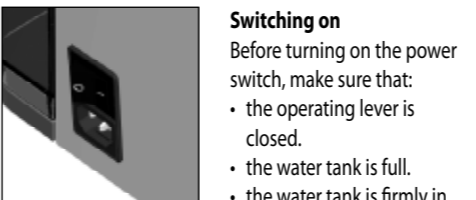

**Switching on**  
Before turning on the power switch, make sure that:  
• the operating lever is closed.  
• the water tank is full.  
• the water tank is firmly in place.  
• the drip tray with the container is completely inserted.

Turn on the machine with the main power switch.

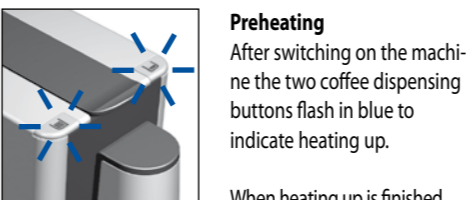

**Preheating**  
After switching on the machine the two coffee dispensing buttons flash in blue to indicate heating up.

When heating up is finished (after approx. 1 min.), the two coffee dispensing buttons remain illuminated in blue. The machine is now ready to use.

**Note**  
Before using for the first time and after long periods of not using (like vacation, e.g.) the internal piping must be flushed out. For details see: **9. Flushing machine and internal piping**

**5. Making coffee**

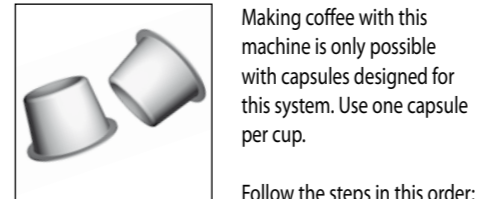

Making coffee with this machine is only possible with capsules designed for this system. Use one capsule per cup.

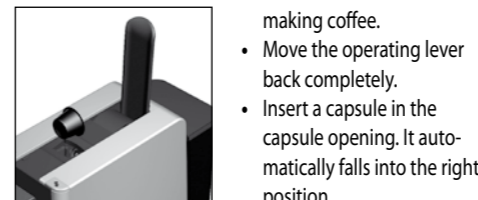

Follow the steps in this order:  
• Be sure there is enough water in the tank before making coffee.  
• Move the operating lever back completely.  
• Insert a capsule in the capsule opening. It automatically falls into the right position.



• Move the operating lever completely forward to load the capsule into the brewing position.  
• Place an empty cup under the dispenser.  
• Press the coffee dispensing buttons:  
 Small cup: 50 ml (Espresso default setting)  
 Large cup: 100 ml (Coffee default setting)  
During the dispensing the chosen button lighting up. The automatic switch-off device is programmable (**8. Programming the amount of water**).

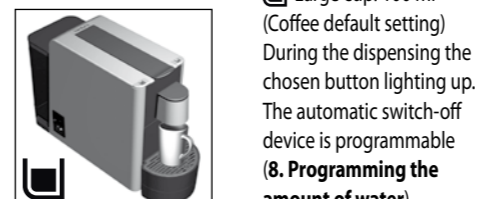

The dispensing process stops automatically when the programmed amount of coffee has been reached. To interrupt the process at any time, press the button again.

**Note**  
• For safety reasons the dispensing button may be pressed only if the operating lever is closed.

**6. After making coffee**

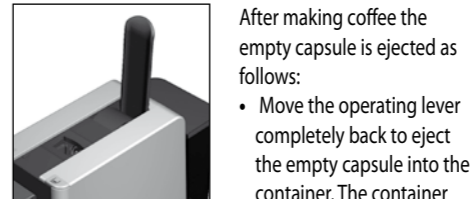

After making coffee the empty capsule is ejected as follows:  
• Move the operating lever completely back to eject the empty capsule into the container. The container holds up to 10 used capsules. It must be emptied regularly.

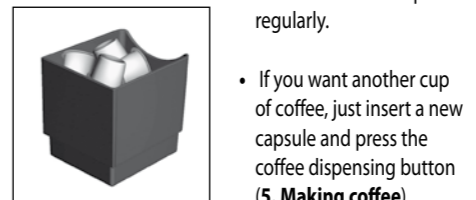

• If you want another cup of coffee, just insert a new capsule and press the coffee dispensing button (**5. Making coffee**).

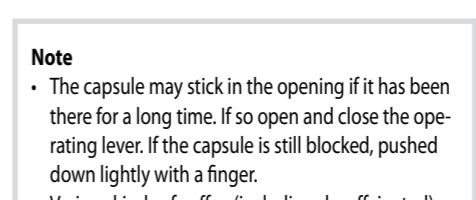

**Note**  
• The capsule may stick in the opening if it has been there for a long time. If so open and close the operating lever. If the capsule is still blocked, pushed down lightly with a finger.  
• Various kinds of coffee (including decaffeinated) capsules are available.

**Tip**  
• Use thick, pre-heated cups for espressos in order to prevent cooling down too quickly. Cups can be pre-heated by rinsing them with hot water.

**Caution**  
To avoid damaging your machine, never use other makes of capsule.

**7. Energy saving mode**

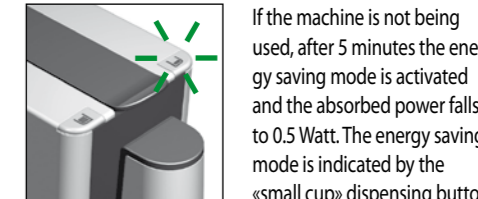

If the machine is not being used, after 5 minutes the energy saving mode is activated and the absorbed power falls to 0.5 Watt. The energy saving mode is indicated by the «small cup» dispensing button lighting up in green.

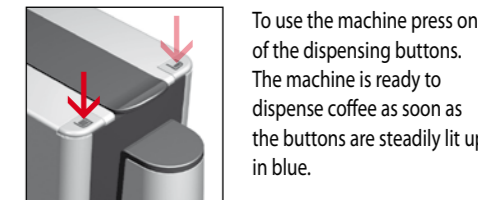

To use the machine press one of the dispensing buttons. The machine is ready to dispense coffee as soon as the buttons are steadily lit up in blue.

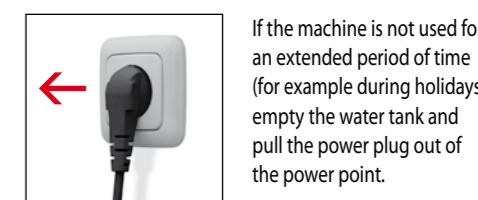

If the machine is not used for an extended period of time (for example during holidays) empty the water tank and pull the power plug out of the power point.

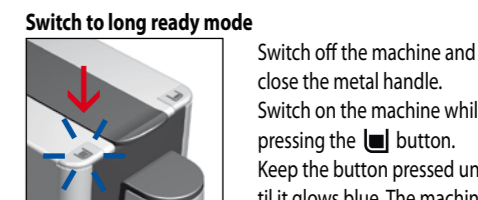

**Switch to long ready mode**  
Switch off the machine and close the metal handle. Switch on the machine while pressing the button. Keep the button pressed until it glows blue. The machine will stay ready now for max. 4 hours. After 4 hours, the machine returns to Energy Safe Mode automatically. To return to the normal energy saving mode please switch on the machine while pressing the button.

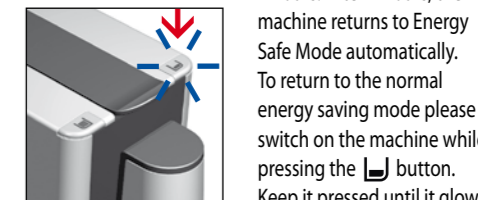

To return to the default quantities, press both dispensing buttons simultaneously for **3 seconds** until they both glow blue. The default quantities are:  
 Small cup, 50 ml  
 Large cup, 100 ml

**8. Programming the amount of water**

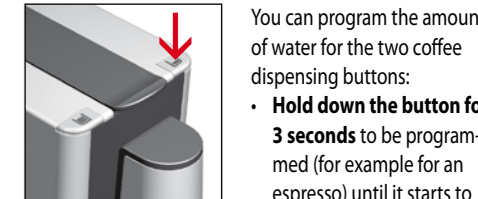

You can program the amount of water for the two coffee dispensing buttons:  
• **Hold down the button for 3 seconds** to be programmed (for example for an espresso) until it starts to flash blue rapidly. The dispensing cycle commences.  
• Once the desired amount in the cup has been obtained, press the button again. The dispensing process stops, the amount of water is programmed and both buttons light up.

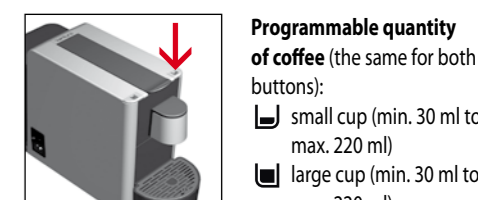

**Programmable quantity of coffee** (the same for both buttons):  
 small cup (min. 30 ml to max. 220 ml)  
 large cup (min. 30 ml to max. 220 ml)

## 9. Flushing out the machine and internal piping

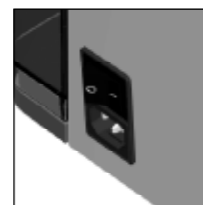

Before using for first time, or after long pauses (for example holidays), the machine must be flushed out. This short procedure thoroughly flushes out and cleans the internal piping.

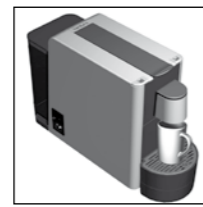

- Turn on the machine with the main power switch.
- Place an empty cup under the coffee/hot water dispenser.
- Make sure that there are no capsules in the opening and close the operating lever.
- Press one of the lighted dispensing buttons (the pump begins working and the water circulates).
- After dispensing the programmed amount of water the pump is automatically deactivated. The procedure can be interrupted or repeated at any time by again pressing the chosen button.

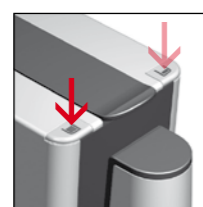

### Caution

- The water coming out of the dispenser is hot!  
Danger of scalding!

## 10. Emptying capsule container and drip tray



The capsule container holds around 10 empty capsules and the upper drip tray around 150 ml of residual water. For hygiene reasons we recommend emptying the capsule container and the drip tray every day.

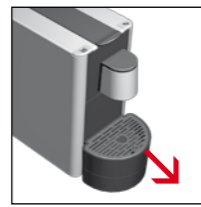

- Hold the drip tray firmly and pull it out by lifting gently.
- Remove the perforated drip tray cover.
- Pull the capsule container out of the drip tray.
- After emptying/cleaning, reassemble the pieces in reverse order and insert them in the machine as far as they go.



### Drip tray and cover, capsule container

- Clean the drip tray, perforated cover and capsule container with tepid water and household detergent.
- Never clean them in the dishwasher!

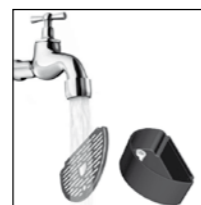
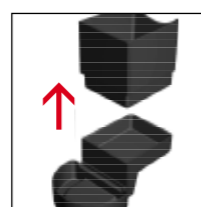

## 11. Cleaning the appliance



### Coffee machine

- Always pull out the power plug before cleaning the machine.
- Never immerse the machine in water or clean it under running water.
- Clean the machine with a damp cloth and allow to dry afterwards.
- Never use abrasive cleaning agents or materials.



### Accessories

- Clean the water tank, capsule container and drip tray with tepid water and household detergent.
- Never clean it in the dishwasher!

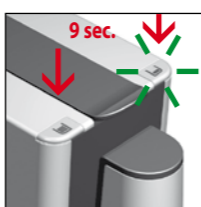

### 3-minutes cleaning mode with cold water

Press both dispensing buttons for **9 Seconds**, until the  button glows green, then release them.

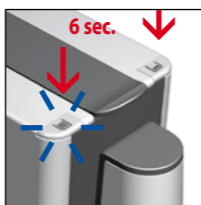

### 3-minutes cleaning mode with hot water

Press both dispensing buttons for **6 Seconds**, until the  button glows blue, then release them.

## 12. Storage / Final disposal

- If the machine will not be used for some time, switch it off and pull out the power plug.
- Store your coffee machine in a dry, dust-free place out of reach of children.
- To avoid frost damage, do not store the machine at temperatures below 5 °C (such as caravans).
- **Important:** If the machine is not used for a long time, rinse it and raise the operating lever.

 Do not dispose of electrical appliances as unsorted municipal waste, use separate collection facilities. Contact your local government for information regarding the collection systems available. When replacing old appliances with new ones, the retailer is legally obligated to take back your old appliance for disposals at least free of charge.

### Technical data

Rated voltage	220-240 V - 50 Hz
Rated power	1000 Watt
Energy saving mode	0.5 Watt
Basic machine dimensions (with depth and height)	ca. 125 x 387 x 261 mm
Length of power cable	max. 1.50 m
Weight (without water)	ca. 5 kg
Water tank capacity	max. 1 l
Materials housing/ water tank	plastic
Radio interference suppression	according to EU standards
Compliance	CE, GS / RoHS

Design or execution changes are reserved in the interest of technical progress.

## 13. Descalce

Drinking water varies according to region. The lime particles in hard drinking water are deposited as residues in the machine and can block the piping and cause damage. To prevent this, be sure to descale the machine at the very least after making 300 to 400 cups of coffee or in any case if the output falls significantly or, in any case after one or two months.

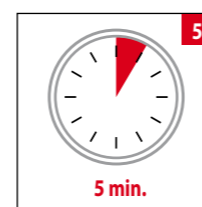
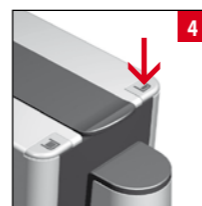

Descalce the machine correctly to prevent damage. So it is essential to follow these instructions:

1. Recommendations: purchase commercially available descaler (descaling liquid), diluted according to the manufacturer's instructions; pour the mixture in the water tank.
2. Make sure the capsule container is empty.
3. Place a large bowl under the dispensing head to collect the descaling liquid and lime residues and turn on the power switch (the coffee dispensing displays flash in blue).
4. As soon as the dispensing displays remain on, press the dispensing button  (small cup). Wait until the dispensing operation is complete.
5. Turn off the machine with the power switch for about five minutes and let the descaling fluid take effect.
6. Rinse the water tank well and refill with water. Place the tank back inside the machine and press the coffee dispensing button. Press the button again until the water tank is empty.

### Caution

- Never clean the machine with vinegar. This causes damage and makes your coffee taste bad!
- Damage caused by incorrect descaling or failure to descale is not covered by the guarantee.

- These liquids are scalding hot! Danger of scalding!

### Note

- Special descalers with colour indicators must be used following the manufacturer's instructions!

### Problems and their remedies

Repairs to your machine may only be carried out at the service centre. Unprofessional repairs and use of non-original replacement parts can be dangerous for the user. In case of unprofessional repairs, no liability will be accepted for resultant damage and the guarantee is invalidated.

If this troubleshooting guide does not help you solve your problem, please contact your local sales point. Important: pull out the power plug immediately in case of faults, defects or possible damage to the machine after a fall.

Problem	Possible cause	Remedy
<b>No coffee output or insufficient output</b>	water tank empty	fill the water tank
	defective pump	contact the service centre
	capsule not (completely) perforated	use a new capsule/contact the service centre
	operating lever open	close lever completely
	scale built up in the machine	descalce the machine
<b>No coffee output</b>	water tank not properly in place	insert water tank correctly
	defective pump	contact the service centre
<b>Cold coffee</b>	heating system defective	contact the service centre
<b>Pump sounds very loud</b>	water tank empty	fill the water tank
	water tank not properly in place	insert water tank correctly
<b>Water drips continuously out of dispensing head</b>	machine /piping blocked with lime deposits	descalce the machine
<b>Occasional drops drip out of dispensing head</b>	empty capsules have remained in the boiler unit	eject the capsule (occasional drops are normal, it is not a defect)
<b>Coffee tastes sour</b>	machine not flushed out enough after descaling	flush out the machine again
	capsule has passed expiration date	use a new capsule
<b>The amount of water programmed per cup is not correct</b>	water tank empty	fill the water tank
	program changed	reprogram
	water quantity dosage not programmable	contact the service centre (for safety reason, dispensing stops after 2 minutes)
<b>Dispensing button  flashes red very quickly</b>	electronic malfunctioning	switch off the machine, wait for 20 minutes and restart it. If the problem persists, contact the service centre
<b>Dispensing button  lights up in green</b>	no malfunctioning. The machine is in energy saving mode	press one of the dispensing buttons
<b>The machine stops dispensing</b>	water tank empty	fill tank with fresh water
	defective pump	contact the service centre
<b>The lever can not be lowered</b>	the used capsules tray is full	empty the used capsule tray
	capsule stuck inside	remove the used capsule

